



P.O. Box 84  
 Charlotte, MI 48813  
 517-204-4492

TO: Eagle Township  
 10505 Grange Rd  
 Eagle, MI 48822

Mid Michigan Health Dept  
 1307 E. Townsend  
 St Johns MI 48879

Date: 8/2/2024

The generator listed below is planning to apply biosolids (sewage sludge) in the township identified on the attached plat map. This notice is provided in accordance with Michigan Part 24 Biosolids Rules, to inform you of our activities within your area, and to give you a basic understanding of the fertilizer value of this material. The generator or NutriGro, Inc. will provide you free of charge any additional information as needed including any record created in accordance with State rules pertaining to the actual biosolids application.

<u>Generator</u>	<u>Owner</u>	<u>Operator</u>
Capital Crossings 13531 Declaration Ct Eagle, Mi 48820	Joe Haddix 14086 W. State Rd Grand Ledge, MI 48837	Travis Metcalf 15245 S. Jones Rd Eagle, MI 48822

The following analytical data represents the average contents of the biosolids that will be applied in your area. The U.S. EPA has developed the maximum limits from over 20 years of research. These limits represent a conservative annual application rate and at no time shall biosolids be applied which exceed any of these maximum values.

Most Recent Biosolids Monitoring Data mg/kg dry					
Pollutant	Result	Limit	Pollutant	Result	Limit
Arsenic	7.21	75	Mercury	0.36	57
Cadmium	1.51	85	Molybdenum	9.62	75
Copper	250.00	4300	Nickel	27.10	420
Lead	9.57	840	Selenium	5.81	100
Nitrogen	49,100	Ag Rate	Zinc	1950.00	7500
Potassium	3,820	Ag Rate	Phosphorus	40,500	Ag Rate

Biosolids are the nutrient-rich organic materials produced during the biological and physical treatment of wastewater. The solids treated during this process produce a stabilized liquid or semi-solid material that contains nutrients required for crop growth, as well as organic matter to condition the soil. Treated biosolids contain the three primary crop nutrients: nitrogen, phosphorus, and potassium. They also contain nutrients that crops need in smaller amounts. These "micronutrients" are not commonly found in commercial fertilizers.

EGLE's, Resource Management Division, regulates the land application of biosolids. The program is endorsed by the Michigan Department of Agriculture and Rural Development, Michigan State University, Michigan Farm Bureau, Michigan Water Environment Association, Michigan Municipal League, U.S. Environmental Protection Agency, U.S. Department of Agriculture, and the U.S. Food and Drug Administration.

If you have additional questions or concerns please do not hesitate to contact me at 517.974.1424.

Sincerely,

Graham Chapman  
 Field Services Manager

Attachments

# EAGLE PLAT MAP



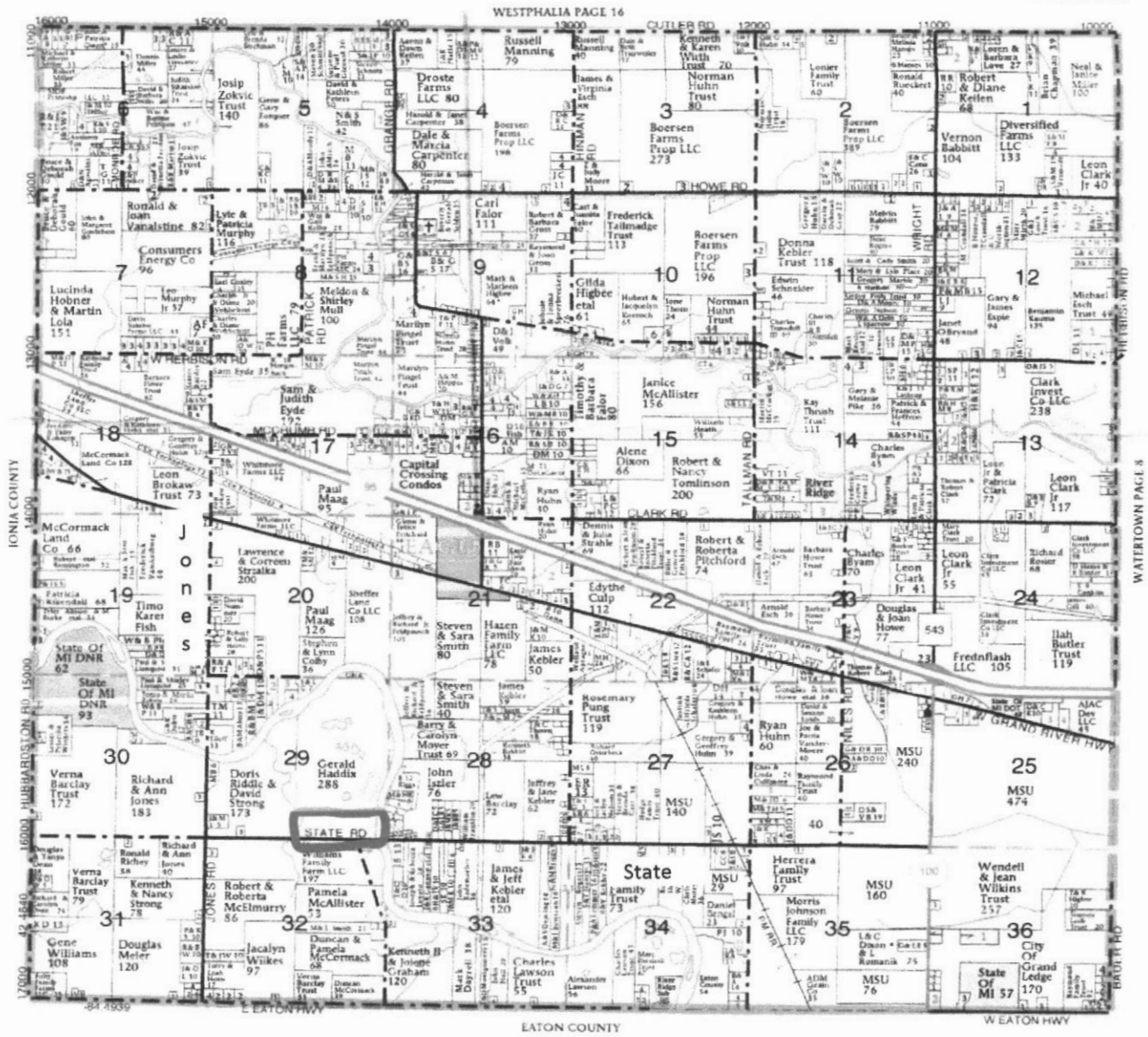
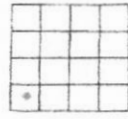

T-5-N • R-4-W

See Page 78-81 For Additional Names

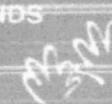

**WALKINGTON**  
**WELL DRILLING**  
 "We Know Where In The Well Your Water Is"  
 Serving your area for 20 years  
 (517) 566-7420 • (877) 484-4103

**I PLEDGE:**

<b>MY HEAD</b> TO CLEARER THINKING		<b>MY HEART</b> TO GREATER LOYALTY	
<b>MY HANDS</b> TO LARGER SERVICE		<b>MY HEALTH</b> TO BETTER LIVING	

© Farm & Home Publishers, Ltd.

Owner: Joe Haddix  
 Operator: Travis Metcalf  
 Address: 15245 S. Jones Rd  
 Grand Ledge, MI 48837

MDEQ ID: 05N04W29-GH02R  
 Nickname: -  
 County: Clinton  
 Township: Eagle